

COVER SHEET

DRAWING NUMBER : MD1009
DRAWING TITLE : ENGINE MOUNT 20XE (NOVA)
REVISION : 2
DATE : 15.09.03
MATERIAL : 5MM MILD STEEL
FINISH : POWDER COAT
COLOUR : MATT BLACK
SCREEN NUMBER : N/A

REVISION DETAILS:

1: 19.12.02
FIRST RELEASE

2: 15.09.03
LINE OF 3 HOLE SIZES CHANGED FROM 13.5mm TO 11mm
LINE OF 3 HOLES MOVED LEFT BY 18mm
WHOLE PROFILE ELONGATED BY 18mm
NEW MID-POINT CUTOUT ADDED TO AVOID LATE CAM COVER
LEFT MOST CORNERS NOW RADIUSED

FLAT PROFILE VIEW

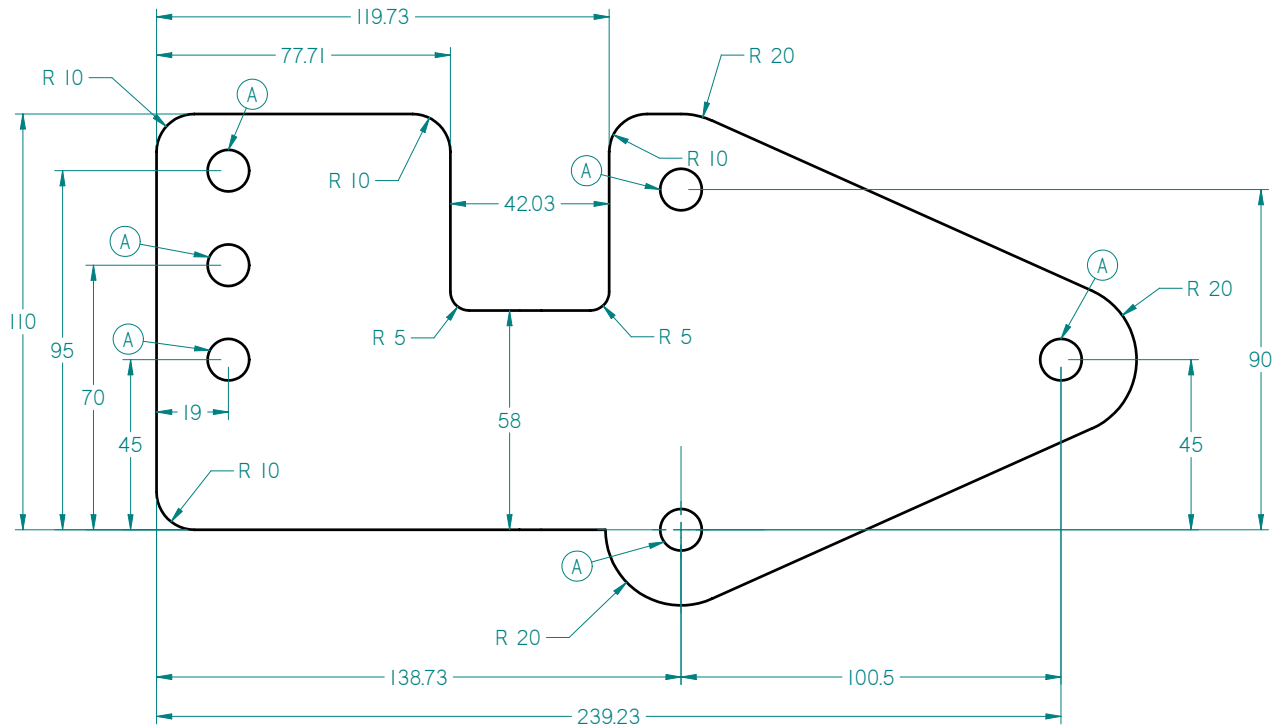

HOLE/INSERT DETAILS:	
A- 11mm	TOTAL 6
B-	
C-	
D-	
E-	

DRAWING TITLE: GEARBOX SPACERS F20/F16 NOVA
MD1006

REV2 26.11.02
5MM MILD STEEL
(c)2002-2006 BRIAN SIDEBOTHAM

VALVERS
<http://www.valvers.com>

FOLDED VIEW

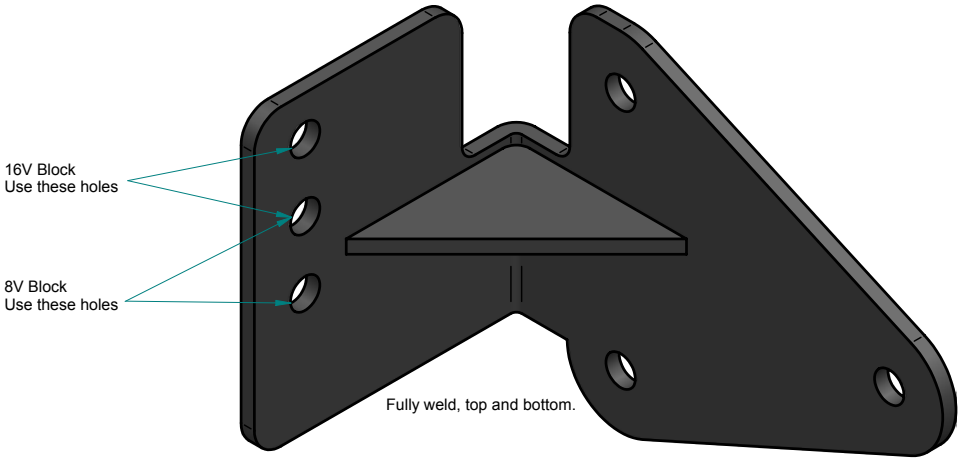
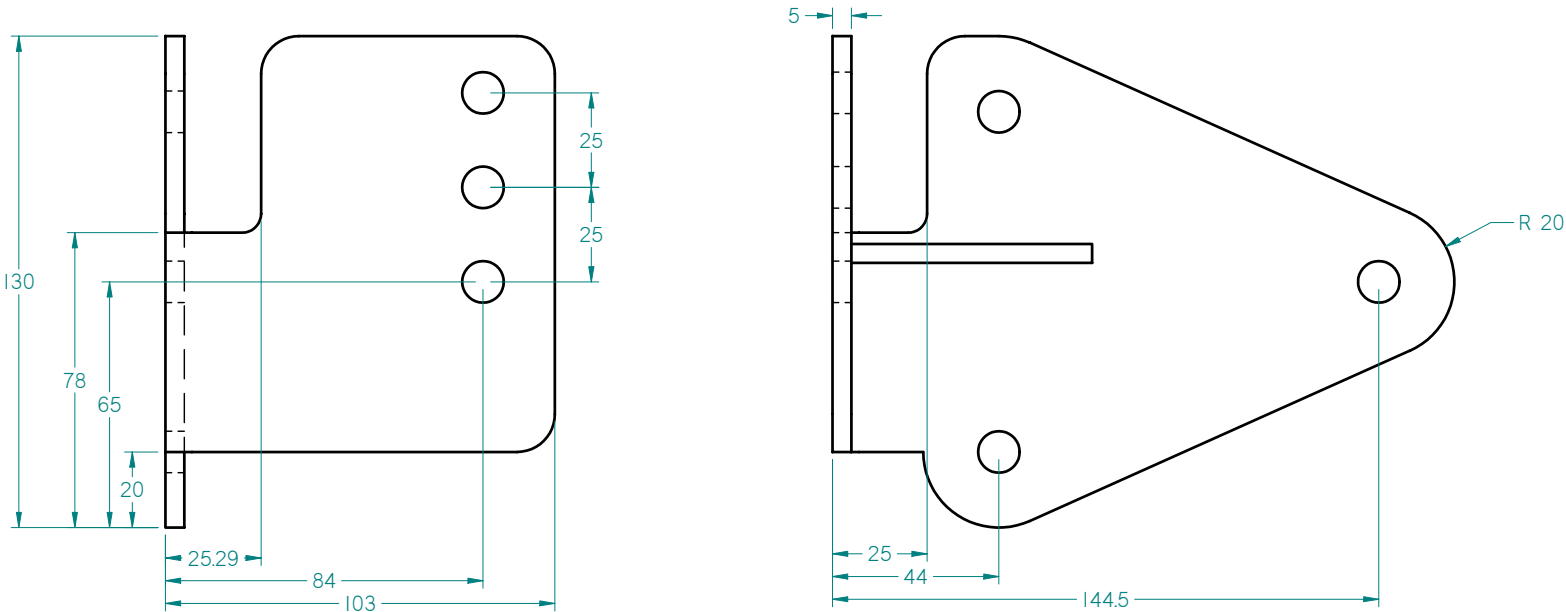

HOLE/INSERT DETAILS:		DRAWING TITLE: GEARBOX SPACERS F20/F16 NOVA	
A- 11mm	TOTAL 6	MD1006	VALVERS http://www.valvers.com
B-		REV2 26.11.02	
C-		5MM MILD STEEL	
D-		(c)2002-2006 BRIAN SIDEBOTHAM	
E-			